

CABLE TIES & MOUNTS

Quick Release Cable Tie

- Quick release cable tie allows multiple use capabilities.

Part No.		Length	Width	Max. Bundle Dia	Min. Tensile Strength
25/pkg.	100/pkg.				
13-254	13-104	4"	.14"	1"	40 lbs.
13-256	13-106	6"	.19"	1-1/2"	50 lbs.
13-258	13-108	7"	.19"	2-1/8"	50 lbs.
13-259	13-109	8"	.19"	2-3/4"	50 lbs.
13-2511	13-1011	11"	.19"	3-1/2"	50 lbs.
13-2514	13-1014	14-1/2"	.19"	4"	50 lbs.

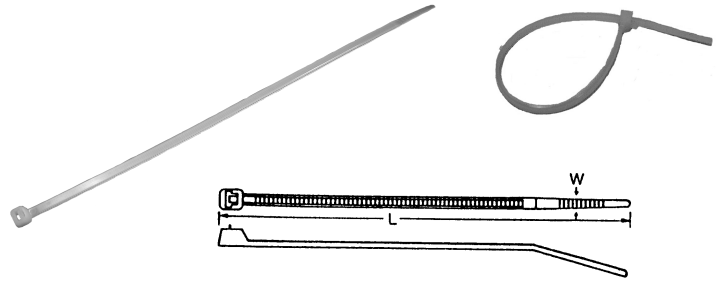

Push Mount Tie

- Material: UL approved NYLON 6/6, 94V-2
- Press cable tie into a pre-drilled hole of 3/16" for simple and secure one-piece harness tying and mounting.

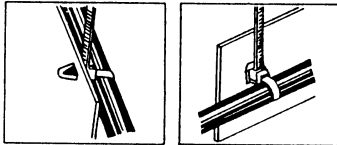

Part No.		Length	Width	Max. Bundle Dia.	Min. Tensile Strength
25/pkg.	100/pkg.				
13-105	13-1005	6-1/8"	.14"	1-9/16"	40 lbs.

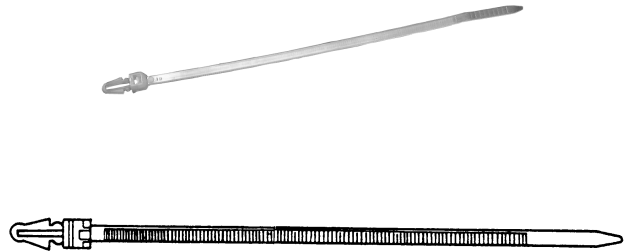

Saddle Type Tie Mounts

- Material: UL approved NYLON 6/6, 94V-2
- Saddle design provides maximum stability to bundles of wire.
- Attach to surface with a screw and secure wire bundles with cable ties.

Part No.		H	L	W	T	B
25/pkg.	100/pkg.					
13-125	13-100	.197"	.75"	.37"	.197"	.134"
13-225	13-200	.275"	.60"	.40"	.197"	.118"
13-325	13-300	.354"	.90"	.63"	.354"	.236"

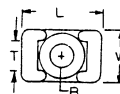

No. 13-225
No. 13-200
No. 13-325
No. 13-300

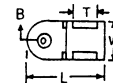

No. 13-125
No. 13-100

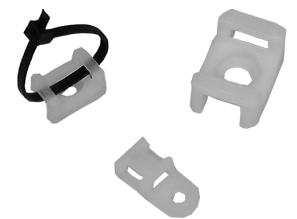

- Material: UL approved Nylon 6/6, 94V-2 (Back with adhesive tape)
 - SELF-ADHESIVE TIE MOUNT is designed to support light weight wire bundles when properly applied on any clean, smooth, grease-free surface. For heavy support, mounting hole is supplied for screws
 - To apply, simply peel off backing paper and apply mount to surface.
- Now cable ties can be inserted to secure wire bundles

Part No.		L	W	H Without Tape	Mounting Hole	T
25/pkg.	100/pkg.					
13-1025	13-1000	.50"	.50"	.125"	-	.12"
13-1125	13-1100	.75"	.75"	.153"	.126"	.17"
13-1225	13-1200	.83"	.83"	.137"	-	.18"
13-1325	13-1300	1.10"	1.10"	.157"	.197"	.19"

Self-Adhesive Tie Mount



No. 13-1025
No. 13-1000



No. 13-1125
No. 13-1100



No. 13-1225
No. 13-1200

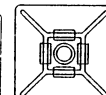

No. 13-1325
No. 13-1300

